



More than a location,  
a great destination.



eventlounge.be

info@eventlounge.be  
+32 (0)2 726 55 26

Bd. Général Wahislaan  
16F, 1030 Brussels



Share.  
Connect.  
Learn.

[eventlounge.be](http://eventlounge.be)

# Menu

All in one concept	6
Plans	8
Event facilities	12
Catering partners	17
Technical partners	19
Hotel partners	20
A great location & Click to discover our other venues in town	23



# All in one concept

Event Lounge is a venue with a trendy and glamorous style, offering you an “all in one” concept package for your events and corporate events: rooms equipped with the most modern audio and video technology, a modular set-up, high-level catering, as well as an experienced and dynamic coordination team.

The originality, modularity and flexibility of Event Lounge allows you to organize a staff party, a product launch, a conference, a seminar, a hybrid event, a lavish gala, an awards ceremony & more.



At Event Lounge, you have **at hand** all the support you need to make your event **unforgettable**.

The **unlimited creativity** of Event Lounge is the reason for its forever growing **success**.

---

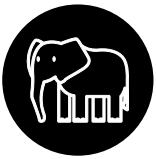

Event Lounge offers an infrastructure of 2500m<sup>2</sup> of Business & Event possibilities. This unique venue can host events from **40 up to 1150 guests** with his main room of **1250 m<sup>2</sup> and 11m height**.

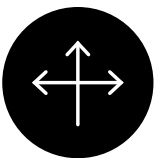

Event Lounge is easily accessible and situated not far from **the heart of Brussels & Brussels National Airport**. Event Lounge has a private parking of **150 cars** and parking facilities in the surroundings for **300 cars**.



Event Lounge cares about the environment and limits its CO<sup>2</sup> emissions wherever possible. In this respect, Event Lounge has signed the "**Green Key, ECO dynamic**" charter and has undertaken a series of steps to limit its ecological footprint.

# Plans

## Ground floor

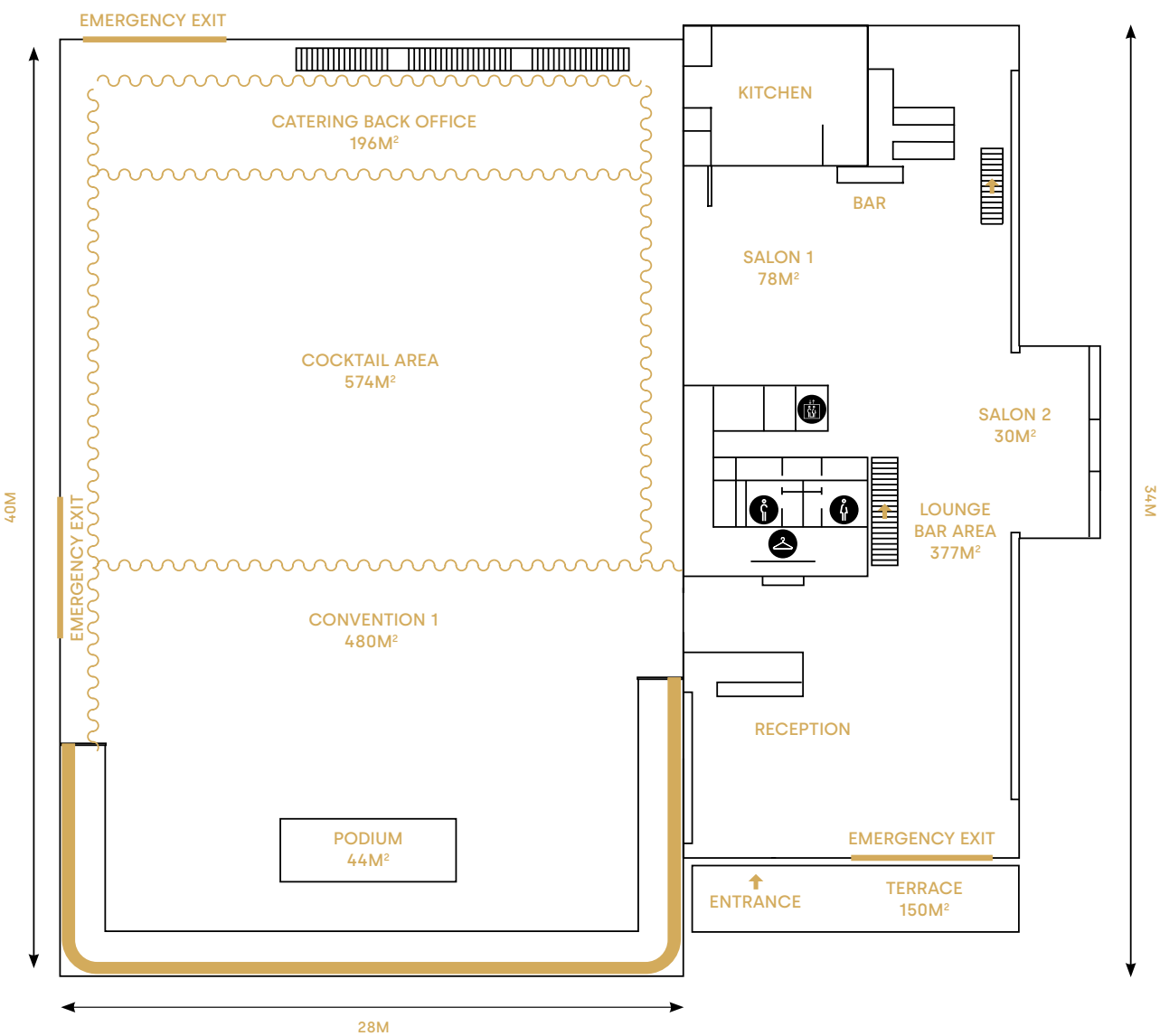

# Plans

## First floor

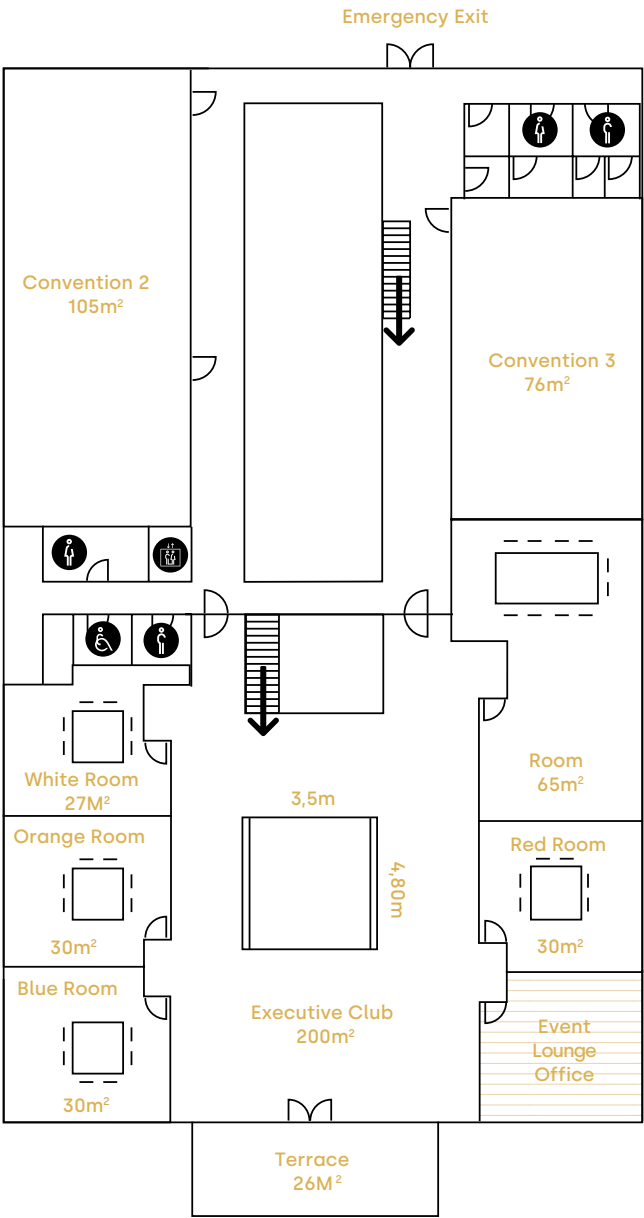





# Event facilities

  
574 m<sup>2</sup>

  
600

  
450

  
320

  
500

  
100

Ground floor

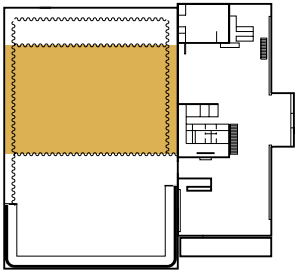



## Cocktail area





  
480 m<sup>2</sup>

  
400

  
300

  
250

  
400

  
100

Ground floor

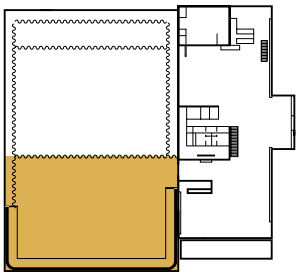



## Convention 1







# Event facilities

  
1250 m<sup>2</sup>

  
1000

  
750

  
570

  
900

  
200

Ground floor

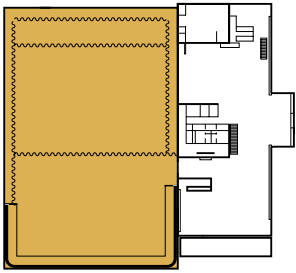

## Studio: cocktail area & convention 1



  
150 - 400 m<sup>2</sup>

  
50 - 400

Ground floor

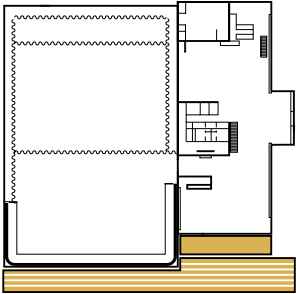

## Terrace & outdoor











# Event facilities



485 m<sup>2</sup>



450



150



100



100

Ground floor

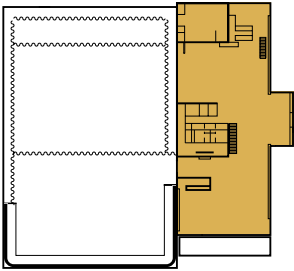

## Lounge bar area & salon's









# Event facilities

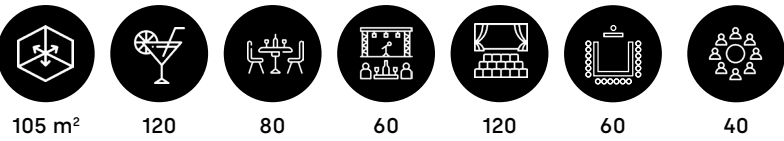

Level 1

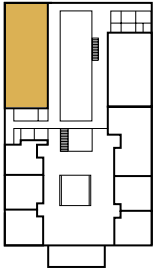

## Convention 2

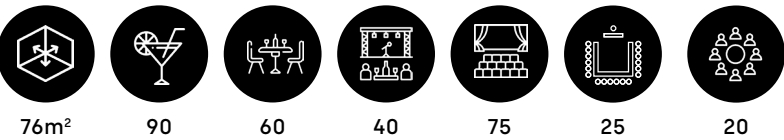

Level 1

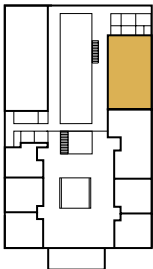

## Convention 3



# Event facilities

  
30 m<sup>2</sup>

  
20

  
8-12

  
65 m<sup>2</sup>

  
30

  
16-20

Level 1

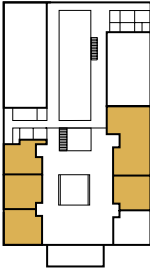

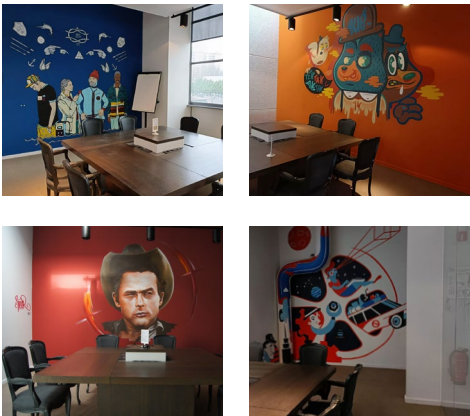

## Meeting rooms





## Executive room





  
200m<sup>2</sup>

  
150

  
80

  
60

  
80

  
25

Level 1

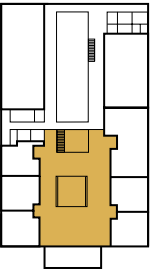

## Executive club









# Memories. Network. Growth.

[eventlounge.be](http://eventlounge.be)



# Catering partners

## Great Traiteur

The innovative partner  
for your dining experience.

Frederic d'Oultremont  
[frederic@great-traiteur.be](mailto:frederic@great-traiteur.be)  
+32 (0)2 880 87 80  
+32 (0)497 10 98 64  
[great-traiteur.be](http://great-traiteur.be)



For your event, every detail is important.

Great traiteur coordinates every aspect of it: products, equipment, service and staging. We are a professional team that leaves nothing to chance and adds the right touches of flavor that make the difference. Special care is given to the sourcing of your products.

We create menus meeting specific dietary requirements, incorporating.

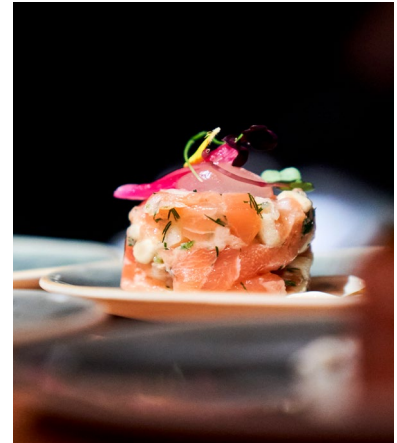

## J&M

Your secret ingredient.

Aïko Vanholder  
[aiko.vanholder@jmcatering.be](mailto:aiko.vanholder@jmcatering.be)  
[info@jmcatering.be](mailto:info@jmcatering.be)  
+32 (0)3 877 88 10  
+32 (0)473 68 94 63  
[jmcatering.be](http://jmcatering.be)



J&M has been active in event catering for private citizens and companies since 1992.

Our team of motivated and passionate employees guarantees a professional approach and strive for absolute perfection for every assignment. Authenticity and innovation go hand in hand at J&M.

Every budget has its prestige. With refined tastes and delirious decoration, we offer you and your guests an unforgettable experience.

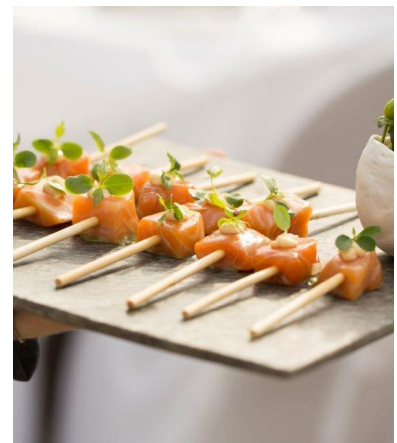

# Catering partners

## Artfood

Cécile Huppertz  
cecile@artfood.be  
+32 (0)2 732 33 85  
+32 (0)477 64 20 50  
artfood.be



The cuisine of Artfood Traiteur is a combination of gastronomy, modernity, aesthetics and ethics.

Founded in 2009 Artfood Traiteur is a modern company that is driven by the notions of excellence, passion and creativity with a human and environmentally responsible vision.

Our company guarantees a unique approach to even the most exclusive and elegant receptions by offering refined menus.



## De Feestarchitect

Tailor-made  
concept catering.

De Feestarchitect  
info@defeestarchitect.be  
+32 (0)9 355 28 93  
defeestarchitect.be



De Feestarchitect does not work with standard formulas, folders or pricelists.

De Feestarchitect team believes that the power of a personal approach is the key to a successful collaboration. They will accompany you in the creation of a tailor-made catering concept, based on your wishes and personality.

You only have to sit back and enjoy your party. The very important detail, like a tailor finishes his clothes.



# Catering partners

## Eating Point

From early morning 'till  
the break of dawn,

Thibault Van Geet  
[thibault@eatingpoint.be](mailto:thibault@eatingpoint.be)  
+32 (0)474 30 66 57  
[eatingpoint.be](http://eatingpoint.be)



Let your guests enjoy quality food, fashion food-corners and hip staff. Ease the networking by creating a natural flow and make your guests feel comfortable.

Each 'themed food corner' is suitable for 50 to 100 guests. At each counter, your guests will discover 3 different cuisines. We serve those delicious meals on both sides of the counter. We adapt our capacity to your needs. First choose your main dish.

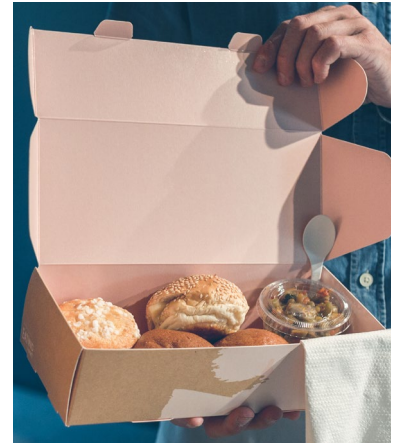

# Technical partners

## GSP2

Event technology

Marc Krevnak  
[marc@gsp2.be](mailto:marc@gsp2.be)  
+32 (0)2 240 10 20  
+32 (0)475 81 10 80  
[gsp2.be](http://gsp2.be)



The human size of the company, the qualitative and flexible approach, the dynamic team of professionals as well as the high level equipment, more than just keywords that will guarantee the success of your event in this special venue.

Bastien Richir and Marc Krevnak and the entire GSP2 Team, are at your disposal for your future events at Event Lounge.



# Hotel partners

## Penta hotels Brussels City Centre

\*\*\*\*

### Reception Desk

+32 (0)2 533 66 66  
[info.brussels.center@pentahotels.com](mailto:info.brussels.center@pentahotels.com)  
[pentahotels.com](http://pentahotels.com)

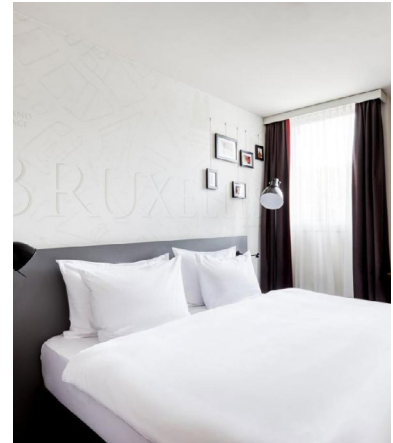

## Gresham Belson Hotel Brussels

\*\*\*\*

### Reception Desk

+32 (0)2 708 31 00  
[resa@gresham-belsonhotel.com](mailto:resa@gresham-belsonhotel.com)  
[gresham-hotels-brussels.com](http://gresham-hotels-brussels.com)

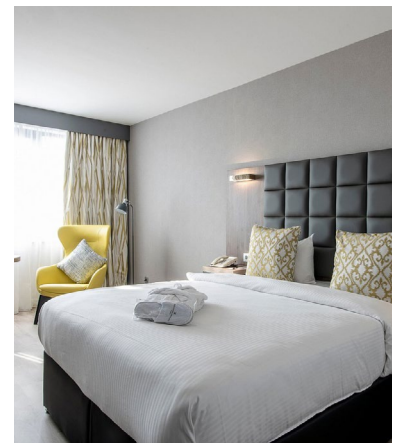



# Hotel partners

## Martin's Brussels EU

\*\*\*\*

Reception Desk

+32 (0)2 230 85 55  
[mbeu@martinshotels.com](mailto:mbeu@martinshotels.com)  
[martinshotels.com](http://martinshotels.com)

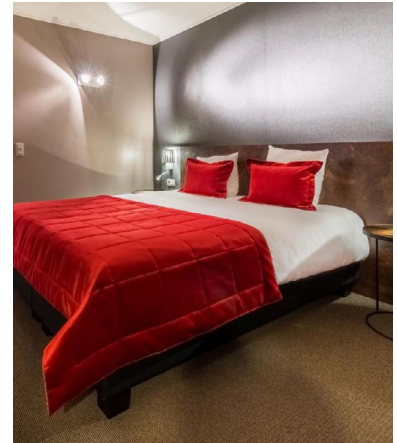

## Courtyard by Marriott Brussels Hotel

\*\*\*\*

Reception Desk

+32 (0)2 708 31 00  
[christine.cornelis@marriott.com](mailto:christine.cornelis@marriott.com)  
[marriott.com](http://marriott.com)

**COURTYARD**<sup>®</sup>  
BY MARRIOTT

Brussels

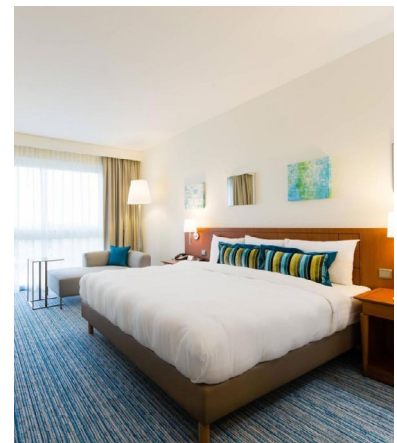



Inspire.  
Experience.  
Build.

[eventlounge.be](http://eventlounge.be)

# A great location

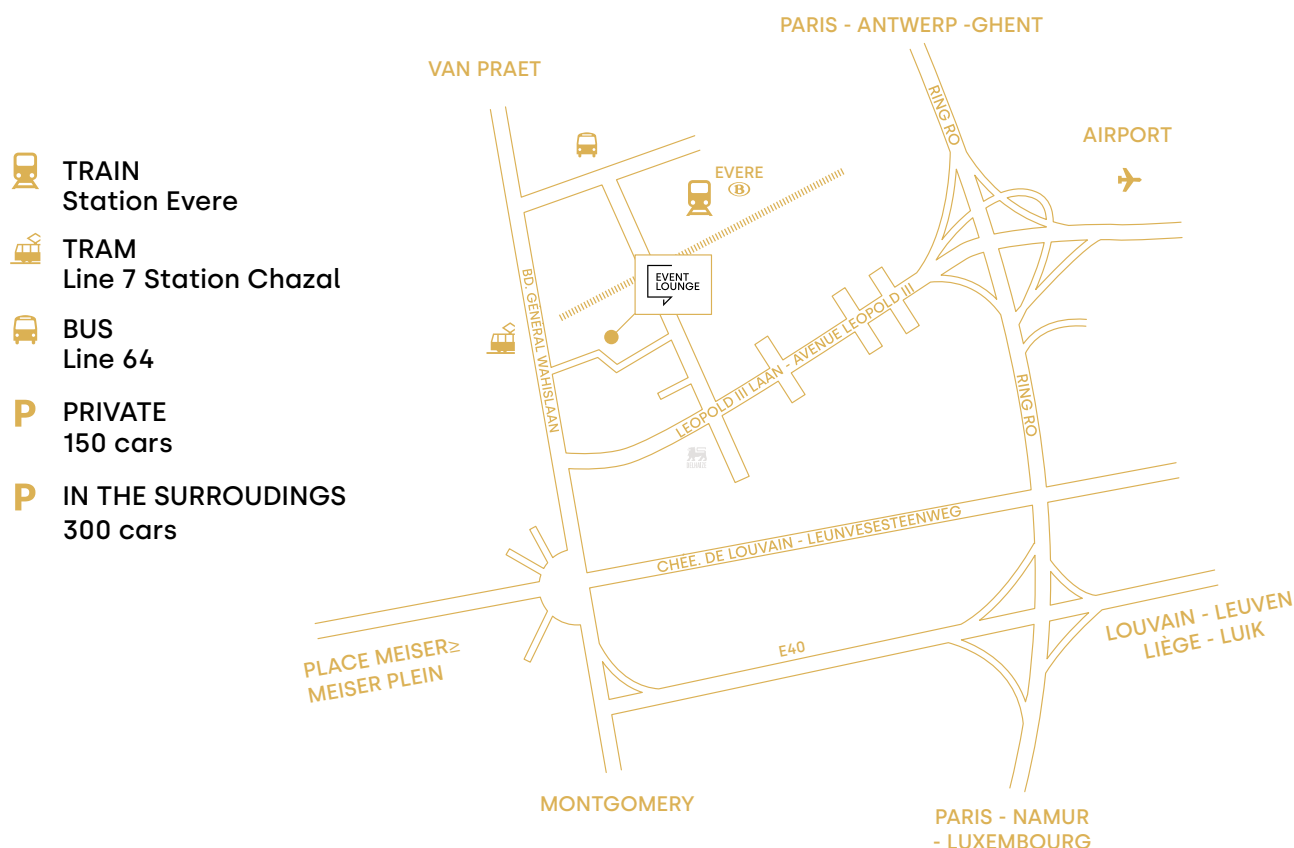

Click to discover our other venues in town



LES JEUX D'HIVER



eventlounge.be

---

info@eventlounge.be  
+32 (0)2 726 55 26

Bd. Général Wahislaan  
16F, 1030 Brussels