



More than a location,
a great destination.



eventlounge.be

info@eventlounge.be
+32 (0)2 726 55 26

Bd. Général Wahislaan
16F, 1030 Brussels



Share.
Connect.
Learn.

eventlounge.be

Menu

All in one concept	6
Plans	8
Event facilities	12
Catering partners	17
Technical partners	19
Hotel partners	20
A great location & Click to discover our other venues in town	23

All in one concept

Event Lounge is a venue with a trendy and glamorous style, offering you an “all in one” concept package for your events and corporate events: rooms equipped with the most modern audio and video technology, a modular set-up, high-level catering, as well as an experienced and dynamic coordination team.

The originality, modularity and flexibility of Event Lounge allows you to organize a staff party, a product launch, a conference, a seminar, a hybrid event, a lavish gala, an awards ceremony & more.



At Event Lounge, you have **at hand** all the support you need to make your event **unforgettable**.

The **unlimited creativity** of Event Lounge is the reason for its forever growing **success**.

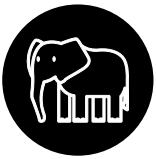

Event Lounge offers an infrastructure of 2500m² of Business & Event possibilities. This unique venue can host events from **40 up to 1150 guests** with his main room of **1250 m² and 11m height**.

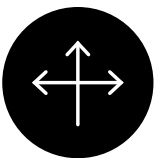

Event Lounge is easily accessible and situated not far from **the heart of Brussels & Brussels National Airport**. Event Lounge has a private parking of **150 cars** and parking facilities in the surroundings for **300 cars**.



Event Lounge cares about the environment and limits its CO² emissions wherever possible. In this respect, Event Lounge has signed the "**Green Key, ECO dynamic**" charter and has undertaken a series of steps to limit its ecological footprint.

Plans

Ground floor

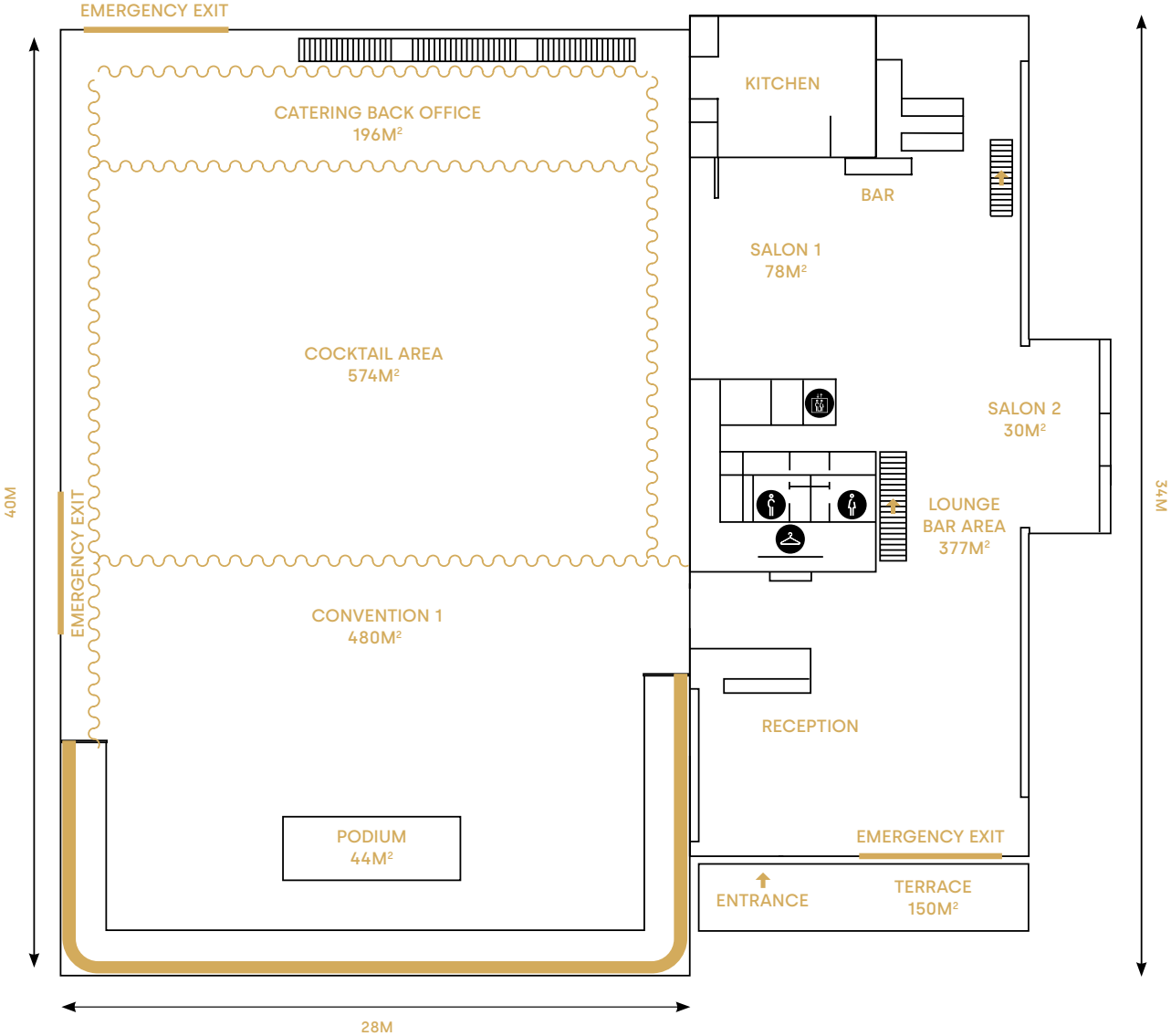

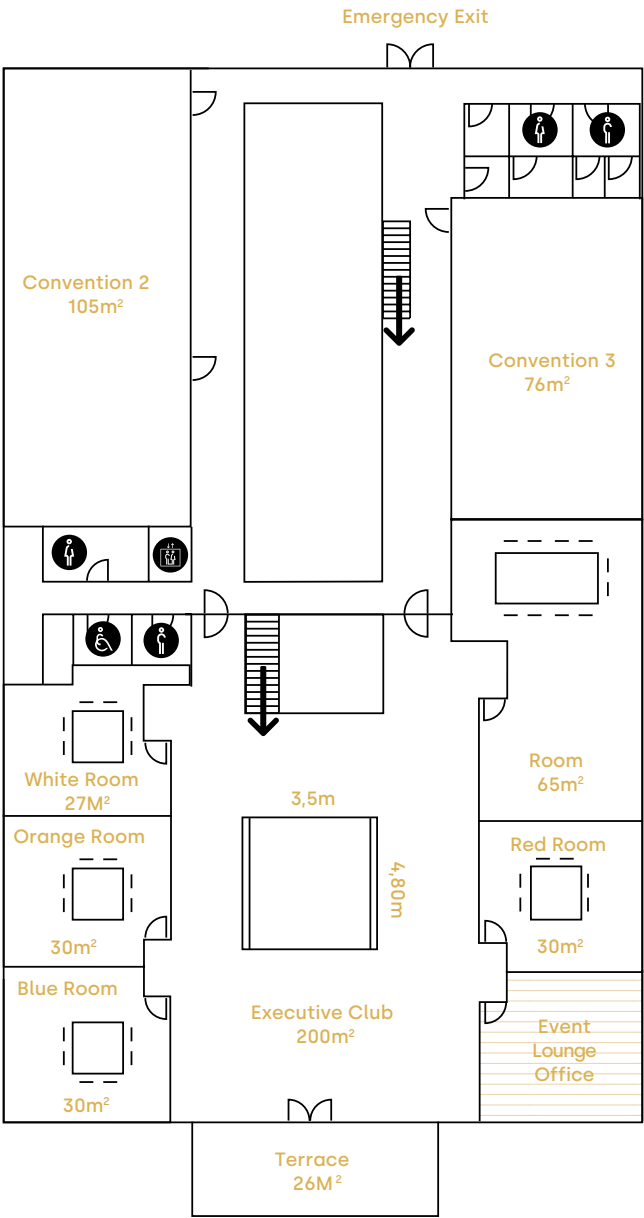

Plans

First floor





Event facilities



574 m²

600



450

320

500

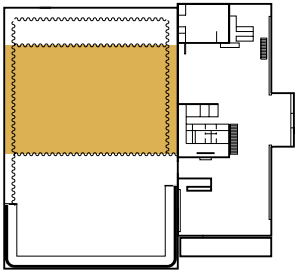

100

Ground floor





Cocktail area





480 m²

400



300

250

400

100

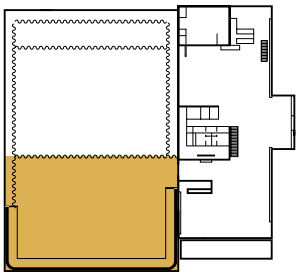
Ground floor





Convention 1





Event facilities



1250 m²

1000



750

570

900

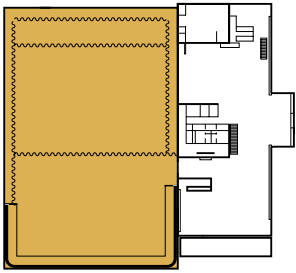

200

Ground floor



Studio: cocktail area & convention 1



150 - 400 m²

50 - 400

Ground floor

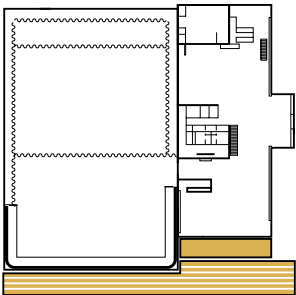

Terrace & outdoor





Event facilities



485 m²



450



150



100



100

Ground floor

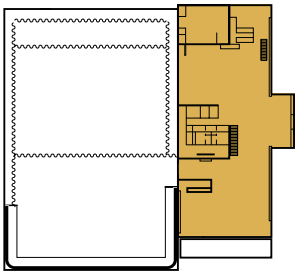

Lounge bar area & salon's

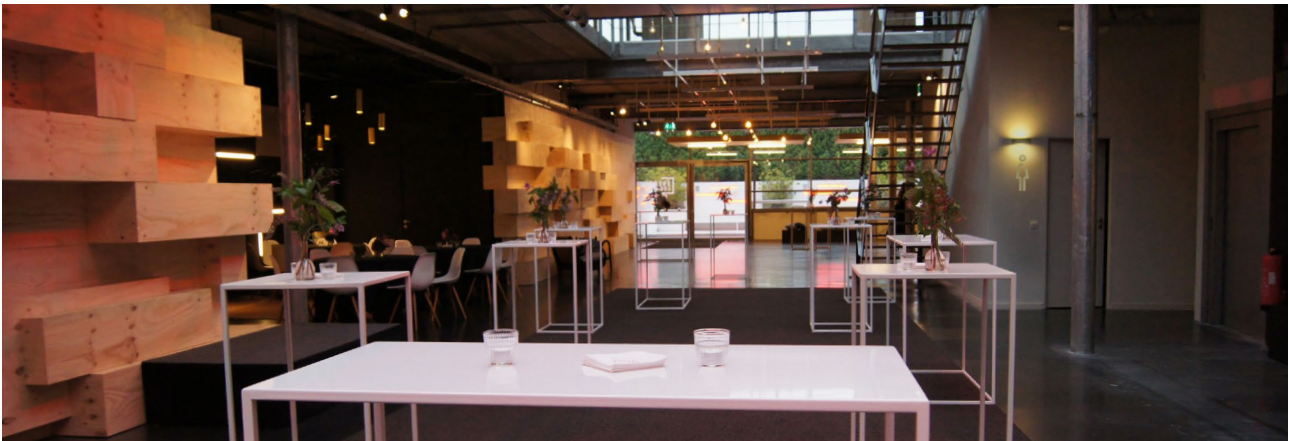



Event facilities



Level 1

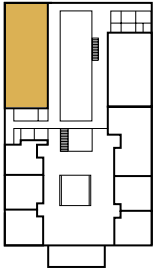

Convention 2

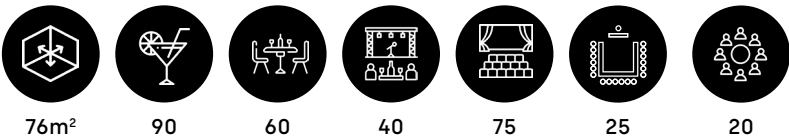

Level 1

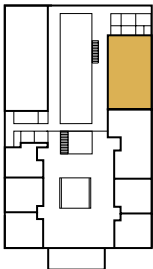

Convention 3



Event facilities



30 m²

20



8-12

65 m²

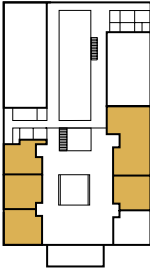

30

16-20

Level 1



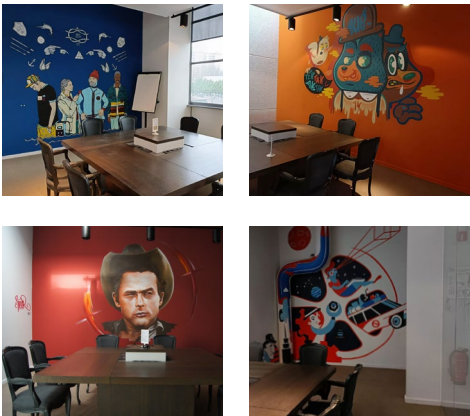

Meeting rooms





Executive room





200m²

150



80

60

80

25

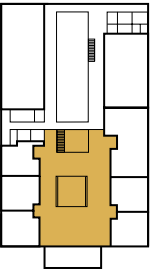
Level 1



Executive club







Memories. Network. Growth.

eventlounge.be

Catering partners

Great Traiteur

The innovative partner
for your dining experience.

Frederic d'Oultremont
frederic@great-traiteur.be
+32 (0)2 880 87 80
+32 (0)497 10 98 64
great-traiteur.be



For your event, every detail is important.

Great traiteur coordinates every aspect of it: products, equipment, service and staging. We are a professional team that leaves nothing to chance and adds the right touches of flavor that make the difference. Special care is given to the sourcing of your products.

We create menus meeting specific dietary requirements, incorporating.

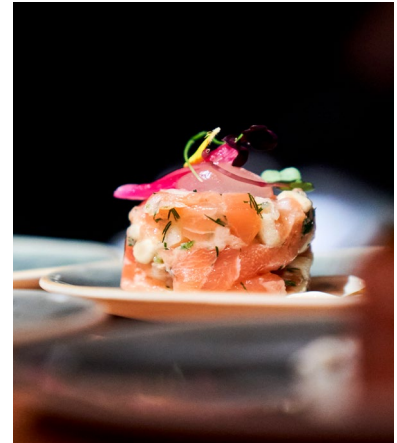

J&M

Your secret ingredient.

Aïko Vanholder
aiko.vanholder@jmcatering.be
info@jmcatering.be
+32 (0)3 877 88 10
+32 (0)473 68 94 63
jmcatering.be



J&M has been active in event catering for private citizens and companies since 1992.

Our team of motivated and passionate employees guarantees a professional approach and strive for absolute perfection for every assignment. Authenticity and innovation go hand in hand at J&M.

Every budget has its prestige. With refined tastes and delirious decoration, we offer you and your guests an unforgettable experience.

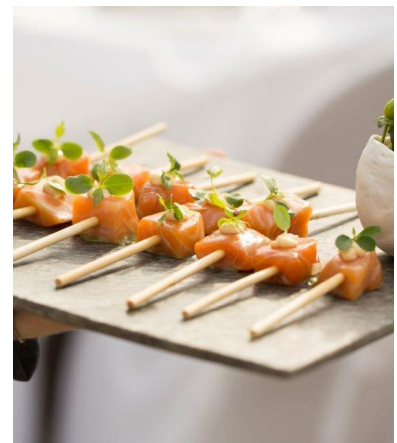

Catering partners

Artfood

Céline Hayette
celine@artfood.be
+32 (0)2 732 33 85
+32 (0)490 66 08 10
artfood.be



The cuisine of Artfood Traiteur is a combination of gastronomy, modernity, aesthetics and ethics.

Founded in 2009 Artfood Traiteur is a modern company that is driven by the notions of excellence, passion and creativity with a human and environmentally responsible vision.

Our company guarantees a unique approach to even the most exclusive and elegant receptions by offering refined menus.



De Feestarchitect

Tailor-made
concept catering.

De Feestarchitect
info@defeestarchitect.be
+32 (0)9 355 28 93
defeestarchitect.be



De Feestarchitect does not work with standard formulas, folders or pricelists.

De Feestarchitect team believes that the power of a personal approach is the key to a successful collaboration. They will accompany you in the creation of a tailor-made catering concept, based on your wishes and personality.

You only have to sit back and enjoy your party. The very important detail, like a tailor finishes his clothes.



Catering partners

Eating Point

From early morning 'till
the break of dawn,

Thibault Van Geet
thibault@eatingpoint.be
+32 (0)474 30 66 57
eatingpoint.be



Let your guests enjoy quality food, fashion food-corners and hip staff. Ease the networking by creating a natural flow and make your guests feel comfortable.

Each 'themed food corner' is suitable for 50 to 100 guests. At each counter, your guests will discover 3 different cuisines. We serve those delicious meals on both sides of the counter. We adapt our capacity to your needs. First choose your main dish.

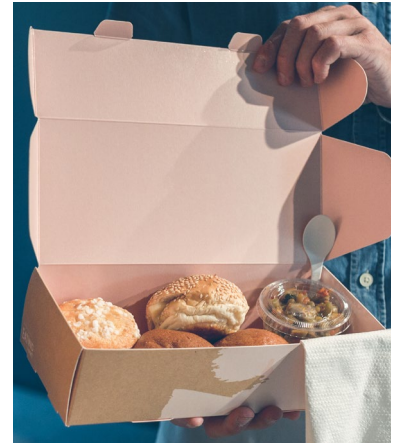

Technical partners

GSP2

Event technology

Marc Krevnak
marc@gsp2.be
+32 (0)2 240 10 20
+32 (0)475 81 10 80
gsp2.be



The human size of the company, the qualitative and flexible approach, the dynamic team of professionals as well as the high level equipment, more than just keywords that will guarantee the success of your event in this special venue.

Bastien Richir and Marc Krevnak and the entire GSP2 Team, are at your disposal for your future events at Event Lounge.



Hotel partners

Penta hotels Brussels City Centre

Reception Desk

+32 (0)2 533 66 66
info.brussels.center@pentahotels.com
pentahotels.com

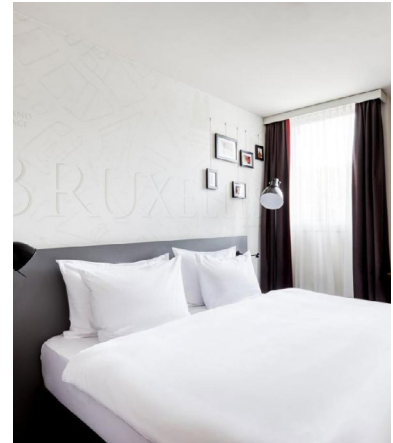

Gresham Belson Hotel Brussels

Reception Desk

+32 (0)2 708 31 00
resa@gresham-belsonhotel.com
gresham-hotels-brussels.com

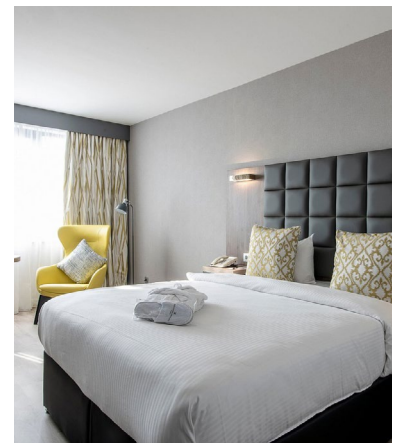

Hotel partners

Martin's Brussels EU

Reception Desk

+32 (0)2 230 85 55
mbeu@martinshotels.com
martinshotels.com

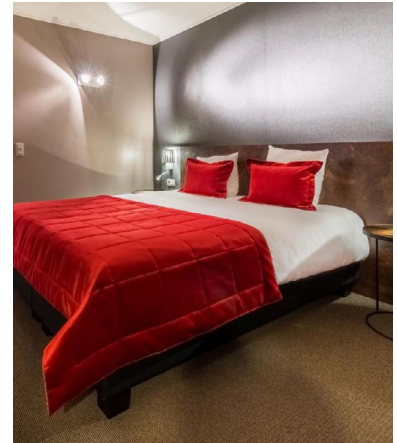

Courtyard by Marriott Brussels Hotel

Reception Desk

+32 (0)2 708 31 00
christine.cornelis@marriott.com
marriott.com

COURTYARD[®]
BY MARRIOTT

Brussels

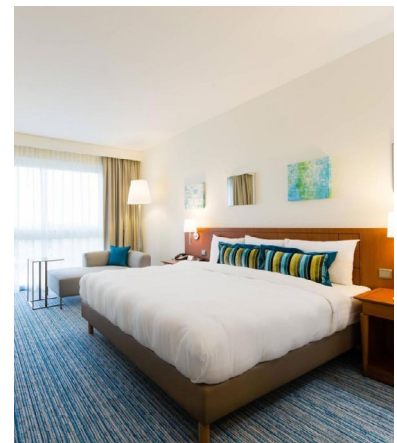



Inspire.
Experience.
Build.

eventlounge.be

A great location

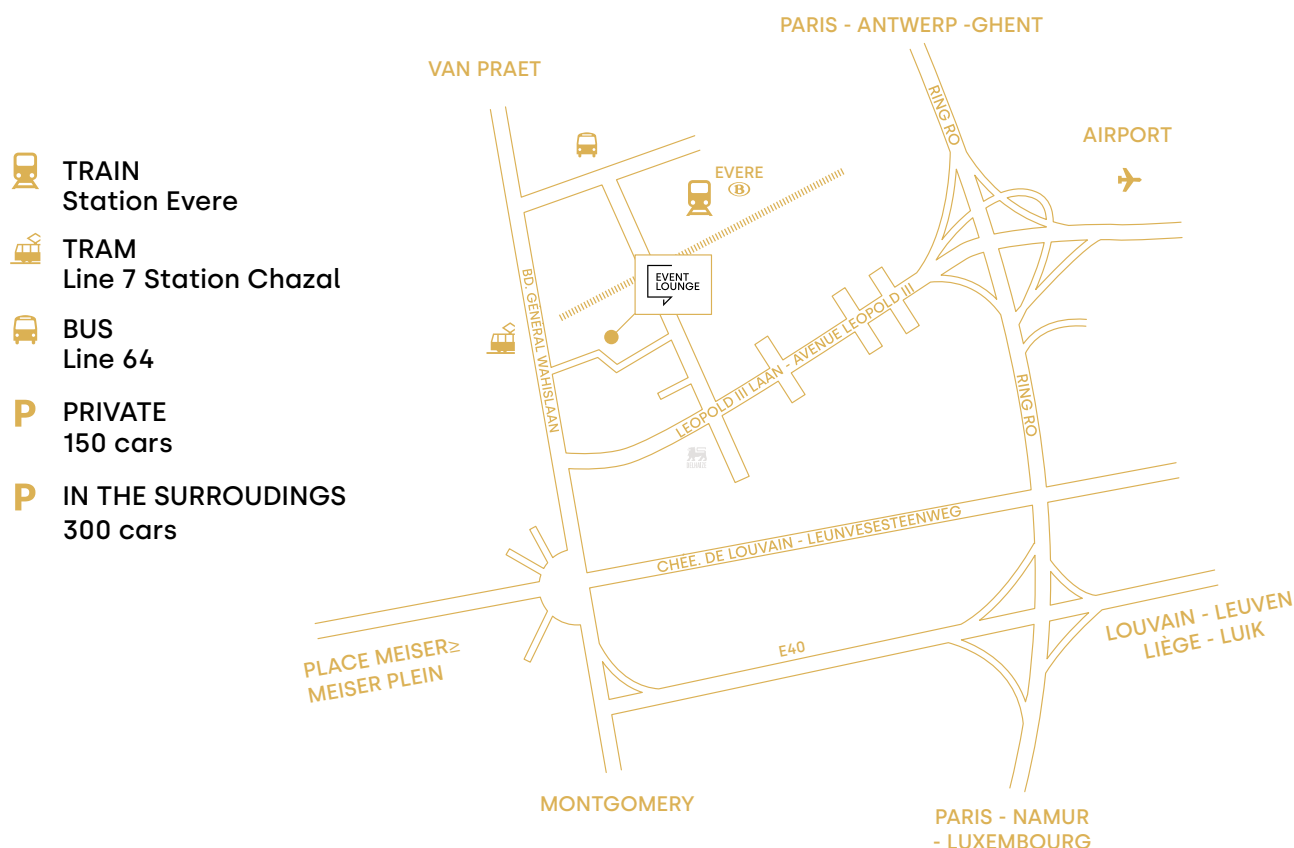

Click to discover our other venues in town



LES JEUX D'HIVER



eventlounge.be

info@eventlounge.be
+32 (0)2 726 55 26

Bd. Général Wahislaan
16F, 1030 Brussels